

08/08/17 G:\0\Projects\17-247A Downtown Blvd WP 5.1B Task 5\CAD\LIGHT BOULEVARD 2.dgn

REVISIONS		
NO.	DESCRIPTION	DATE

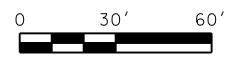
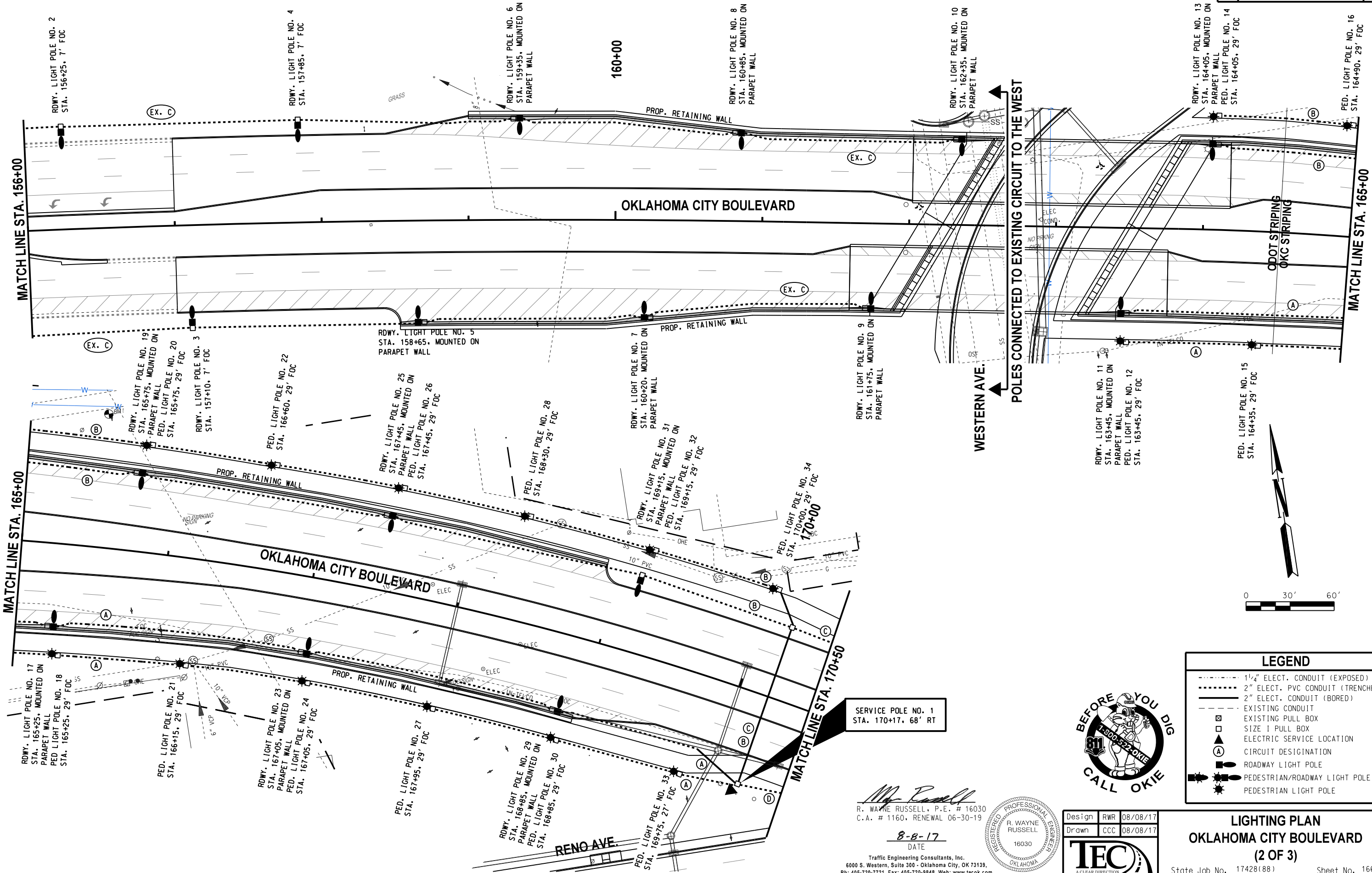

**LEGEND**

- 1 1/2" ELEC. CONDUIT (EXPOSED)
- 2" ELEC. PVC CONDUIT (TRENCHED)
- 2" ELEC. CONDUIT (BORED)
- - - EXISTING CONDUIT
- ☐ EXISTING PULL BOX
- ☐ SIZE I PULL BOX
- ⊙ ELECTRIC SERVICE LOCATION
- ⊙ CIRCUIT DESIGNATION
- ⊙ ROADWAY LIGHT POLE
- ⊙ PEDESTRIAN/ROADWAY LIGHT POLE
- ⊙ PEDESTRIAN LIGHT POLE



*R. Wayne Russell*  
 R. WAYNE RUSSELL, P.E. # 16030  
 C.A. # 1160, RENEWAL 06-30-19

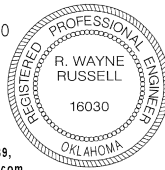

Design	RWR	08/08/17
Drawn	CCC	08/08/17



**LIGHTING PLAN**  
**OKLAHOMA CITY BOULEVARD**  
 (2 OF 3)

State Job No. 17428(88) Sheet No. 166